

## HOMESEAL LDS SOLIFIT-1

[www.knaufinsulation.com](http://www.knaufinsulation.com)

### 1-SIDED ADHESIVE TAPE FOR DETAILING

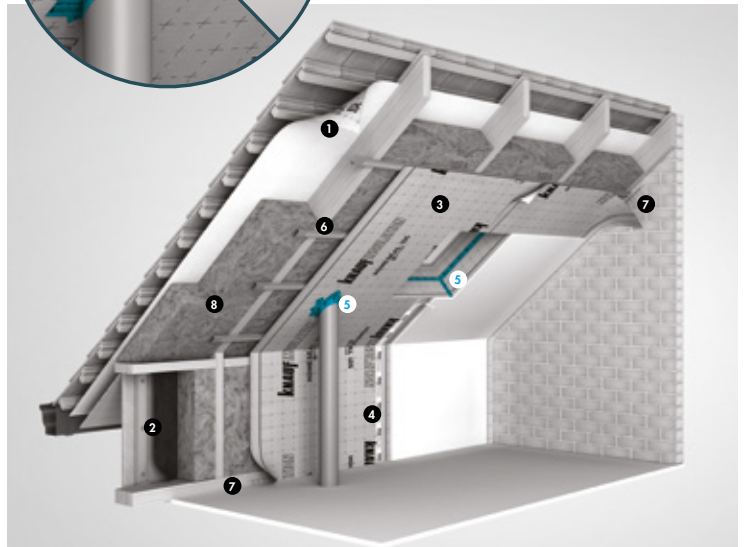
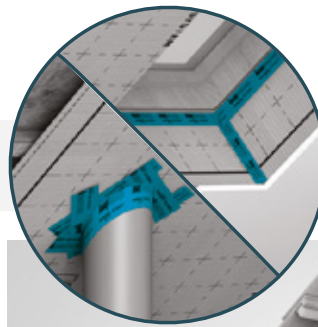

### PRODUCT DESCRIPTION

Solventfree, one-sided elastic adhesive tape made of high density polyethylene (HDPE), for detailing, closing gaps and surrounding building parts.

HOMESEAL<sup>®</sup>  
SYSTEM

#### Weather membranes

- HOMESEAL LDS 0.02
- 1 HOMESEAL LDS 0.04
- HOMESEAL LDS 0.04 FIXPLUS
- 2 HOMESEAL LDS 0.02 UV
- HOMESEAL LDS 0.02 UV FIXPLUS

#### Vapour control layers

- HOMESEAL LDS 2
- HOMESEAL LDS 5
- HOMESEAL LDS 35
- HOMESEAL LDS 40
- 3 HOMESEAL LDS 100
- HOMESEAL LDS 100 ALUPLUS
- HOMESEAL LDS 200 ALUPLUS
- HOMESEAL LDS FLEXPLUS

#### Tapes and sealants

- 4 HOMESEAL LDS SOLIPLAN
- 5 HOMESEAL LDS SOLIFIT-1
- 6 HOMESEAL LDS SOLIFIT-2
- 7 HOMESEAL LDS SOLIMUR 310

#### Insulation

- 8 KNAUF INSULATION MINERAL WOOL

### SPECIFICATIONS

Release foil	Silicon paper
Adhesive tape carrier	Reinforced HDPE film
Adhesive	Acrylate dispersion, solvent free
Colour of adhesive tape carrier	Blue
Temperature resistance	-40° C to +80° C
Installation temperature	> -10° C, recommended > +5° C
Thickness	0.37 mm
Roll width	60 mm
Roll length	25 m

## HOMESEAL LDS SOLIFIT-1

[www.knaufinsulation.com](http://www.knaufinsulation.com)

### ADDITIONAL INFORMATION

#### Applications

For use as a flexible and extensible airtight and vapour closed connection of the Homeseal LDS vapour control layers on details. Due to its stretch properties, this tape is ideal for closing gaps around pipes and ductwork in connection to the vapour control layers and surrounding building parts such as metal and wooden furrings, walls, ceilings and floors.

#### Suitable for substrates

- Homeseal LDS vapour control layers,
- Vapour control layers according to EN 13984,
- Wood-based panels with solid surface, oriented strand boards (OSB) according to EN 300,
- Planed timber structures,
- Corrosion free metal surfaces and planed timber elements in the interior,
- Components of PVC and PE. Bonding to plasterboard and gypsum fibre boards.

#### Resistance of the material combinations to ageing

Properly performed adhesions with certified system components are highly resistant to ageing and meet the requirements of ETAG 007 (Guideline for European Technical Approval of timber building kits).

#### Instructions for use

Please observe the relevant installation guidelines and information provided within the packaging guidance icons. In addition, the relevant standards and recognised rules of technology apply.

#### Storage

Adhesive tapes should be stored at room temperature and normal humidity (50-70%) and protected from direct sunlight, rain and snow.

### APPLICATION GUIDELINES



Place the Homeseal LDS Solifit-1, 1-sided adhesive tape for detailing, to seal the connections and gaps between vapour control layers and surrounding buildings parts



Use some pressure to ensure the proper adhesion of the tape on the substrates



The tape is for interior use only

## ART.: 504874